

# STAINLESS STEEL FITTINGS – SS304 / 316

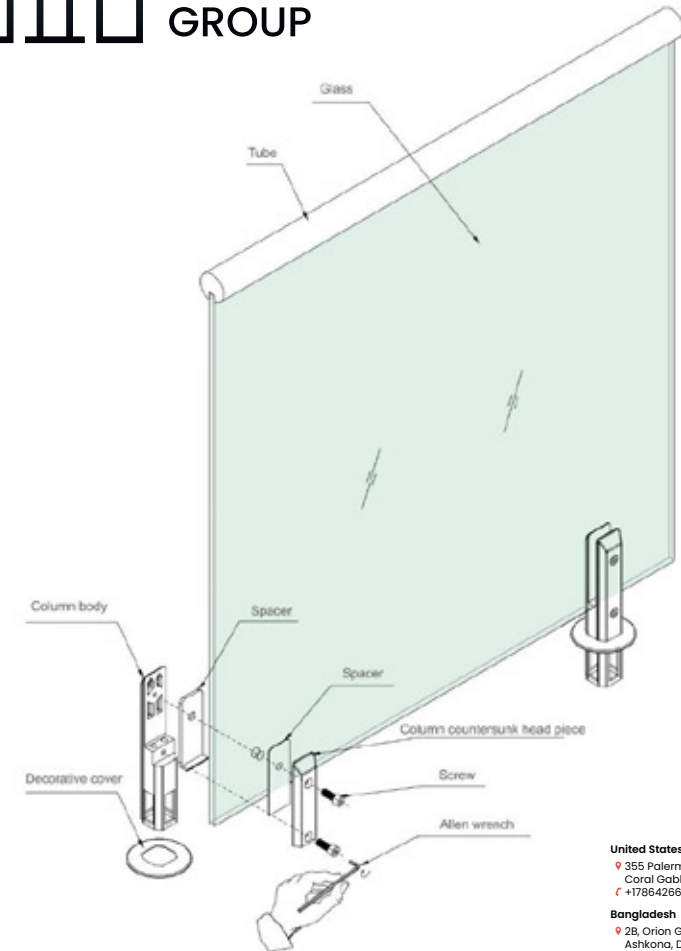

## Installation steps:

1. The first two columns of the same fixed level, a good set of decorative cover;
2. Unscrew the side screws, removed the pads;
3. Place the pads wrap the glass edge;
4. Place the wrapped pad is placed in a glass column vessel;
5. Tighten the screws;

## United States

355 Palermo Ave  
Coral Gables, Florida 33134, USA  
+17864266079

## Bangladesh

28, Orion Green Garden, 285  
Ashkon, Dhaka 1230, Bangladesh  
+1 818 900 9852

## Colombia

Ingeniería y Desarrollo: Carrera  
14# 127 a 45 Bogotá, Colombia  
+57 311 6535901

## Hong Kong

161~167# Des Voeux Rd Central,  
Central, Hong Kong  
+86-535-6723166  
+86-535-6723171 / 67231729

## United Kingdom

18 King William Street, London,  
EC4N 7BP  
020 3375 8046





### Installation Diagram of Glass Balustrade

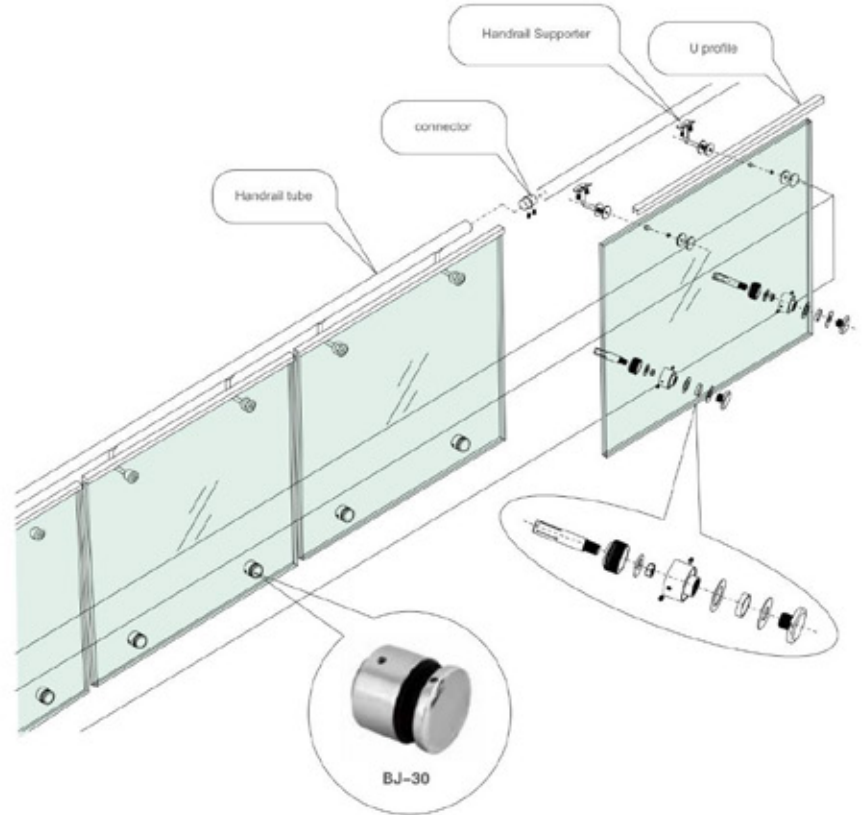

**YS-33**

Material: SUS304/SUS316 Stainless Steel  
Finish: Satin/Polish/PVD

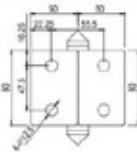

**YS-34**

Material: SUS304/SUS316 Stainless Steel  
Finish: Satin/Polish/PVD

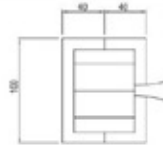

**YS-35**

Material: SUS304/SUS316 Stainless Steel  
Finish: Satin/Polish/PVD

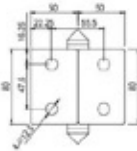

Note: The tailgate glass which carry horizontal load is nominal thickness not less than 12mm tempered glass or nominal thickness not less than 16.76MM of tempered laminated glass. When the height from the lowest point of the tailgate glass to one side floor is above 3m or 3M, 5m 5m or below that should use nominal thickness of not less than 16.76 tempered glass. When the height over 5m that shall not be used the tailgate glass to carry horizontal load. (reference JGJ 113-2009<< architectural glass application technology regulations>>)





**BJ-51DG**

Material: SUS304/SUS316 Stainless Steel  
Finish: Satin/Polish

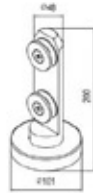

**BJ-54**

Material: SUS304/SUS316 Stainless Steel  
Finish: Satin/Polish



**BJ-56**

Material: SUS304/SUS316 Stainless Steel  
Finish: Satin/Polish

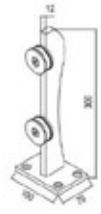

**BJ-48**

Material: SUS304/SUS316 Stainless Steel  
Finish: Satin/Polish



**BJ-55**

Material: SUS304/SUS316 Stainless Steel  
Finish: Satin/Polish



**BJ-52**

Material: SUS304/SUS316 Stainless Steel  
Finish: Satin/Polish



**BJ-59**

Material: SUS304/SUS316 Stainless Steel  
Finish: Satin/Polish

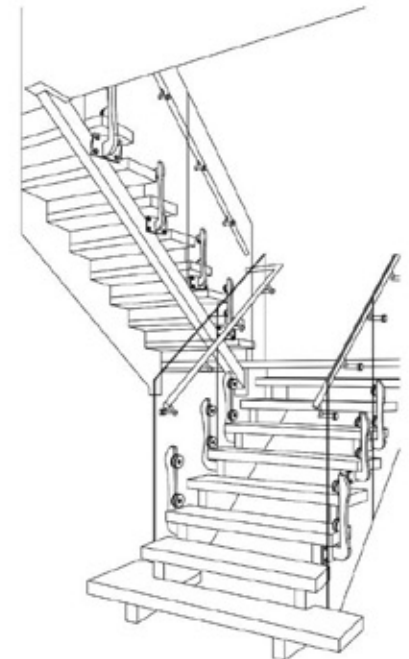
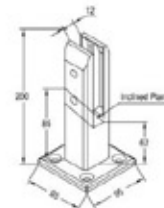







**MQ-30**

Material: SUS304/SUS316 Stainless Steel  
Finish: Satin/Polish/PVD

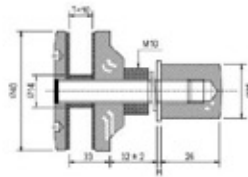

**MQ-22**

Material: SUS304/SUS316 Stainless Steel  
Finish: Satin/Polish/PVD

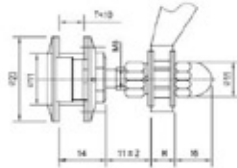

**MQ-31**

Material: SUS304/SUS316 Stainless Steel  
Finish: Satin/Polish/PVD

A	B	D	T1	T2
33	71	48	5	6
26	43	30	5	6

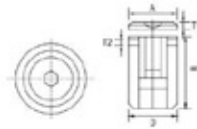

**MQ-24**

Material: SUS304/SUS316 Stainless Steel  
Finish: Satin/Polish/PVD

A	B	D	T1	T2
33	71	48	5	6
26	43	30	5	6

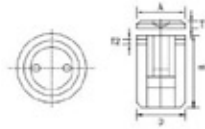

**MQ-32**

Material: SUS304/SUS316 Stainless Steel  
Finish: Satin/Polish/PVD

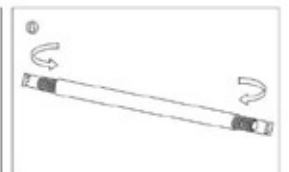
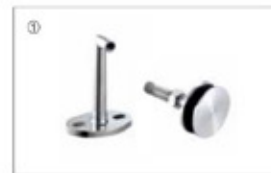
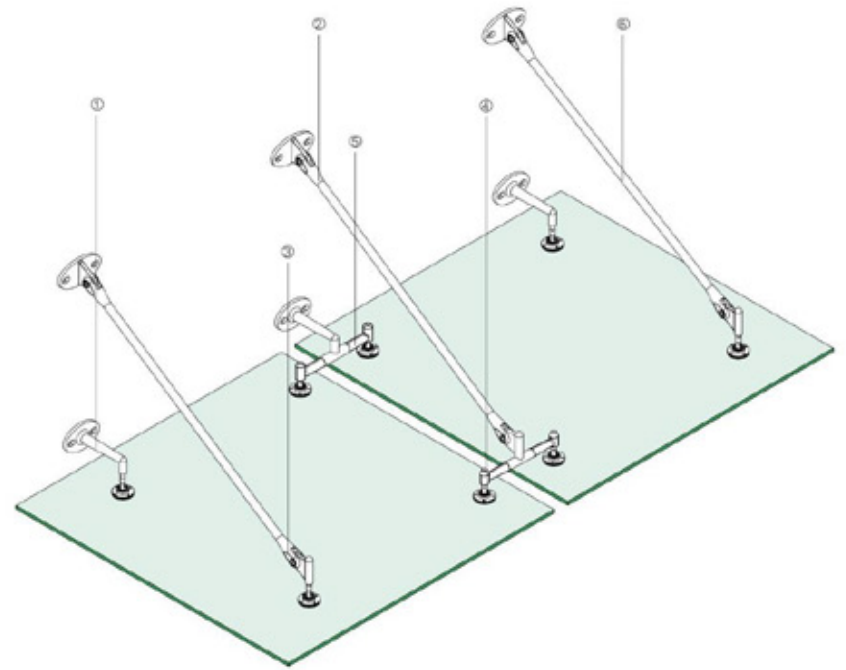
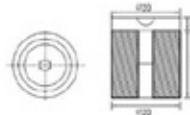



**MQ-34**  
Material: SUS304/SUS316 Stainless Steel  
Finish: Satin/Polish/PVD

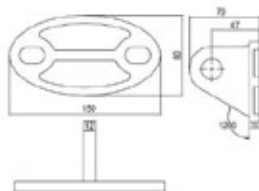

**MQ-41**  
Material: SUS304/SUS316 Stainless Steel  
Finish: Satin/Polish/PVD

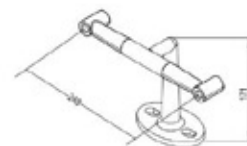

**MQ-37**  
Material: SUS304/SUS316 Stainless Steel  
Finish: Satin/Polish/PVD



**MQ-42**  
Material: SUS304/SUS316 Stainless Steel  
Finish: Satin/Polish/PVD

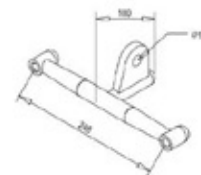

**GH-35**  
Material: SUS304/SUS316 Stainless Steel  
Finish: Satin/Polish/PVD

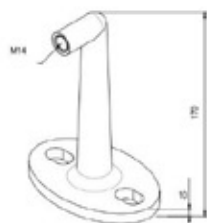

**CH-36**  
Material: SUS304/SUS316 Stainless Steel  
Finish: Satin/Polish/PVD

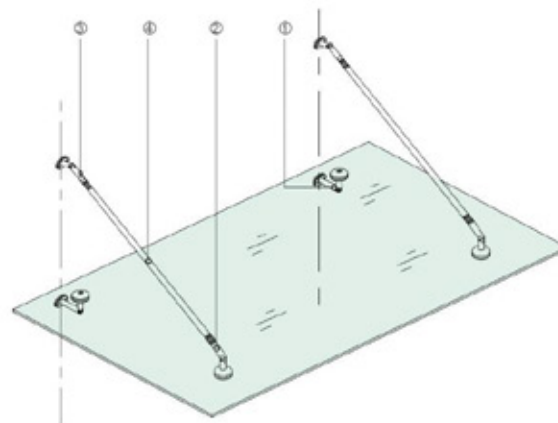
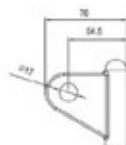



**GH-16**

Material: SUS304/SUS316 Stainless Steel  
Finish: Satin/Polish/PVD

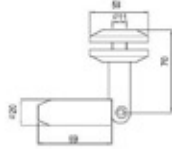

**LTZ-01**

Material: SUS304/SUS316 Stainless Steel  
Finish: Satin/Polish/PVD

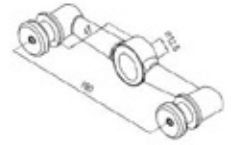

**GH-10**

Material: SUS304/SUS316 Stainless Steel  
Finish: Satin/Polish/PVD



**LTZ-02**

Material: SUS304/SUS316 Stainless Steel  
Finish: Satin/Polish/PVD

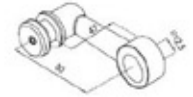

**GH-64**

Material: SUS304/SUS316 Stainless Steel  
Finish: Satin/Polish/PVD

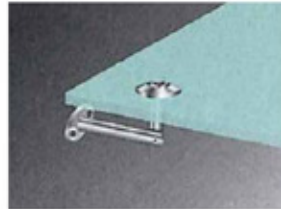
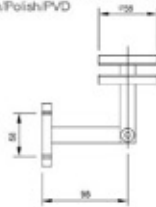

**LTZ-03**

Material: SUS304/SUS316 Stainless Steel  
Finish: Satin/Polish/PVD

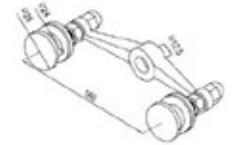

**Installation Diagram**

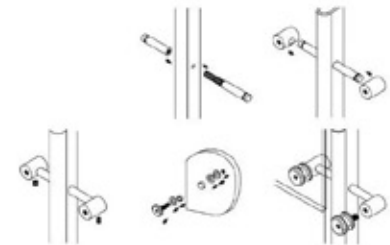
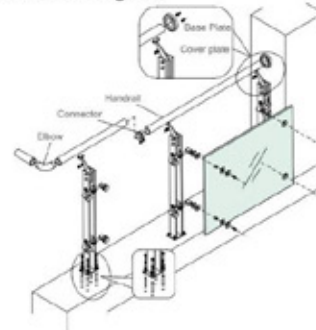

Allowable Load Glass Suspension Clamp			
No.	Item		Allowable load
1	MQ-33		4000
2	MQ-34		4000







**LTZ-04**

Material: SUS304/SUS316 Stainless Steel  
Finish: Satin/Polish/PVD



**LTZ-07**

Material: SUS304/SUS316 Stainless Steel  
Finish: Satin/Polish/PVD

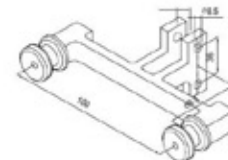

**LTZ-05**

Material: SUS304/SUS316 Stainless Steel  
Finish: Satin/Polish/PVD

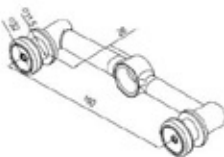

**LTZ-08**

Material: SUS304/SUS316 Stainless Steel  
Finish: Satin/Polish/PVD

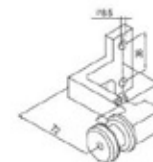

**LTZ-06**

Material: SUS304/SUS316 Stainless Steel  
Finish: Satin/Polish/PVD

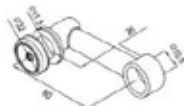

**LTZ-09**

Material: SUS304/SUS316 Stainless Steel  
Finish: Satin/Polish/PVD

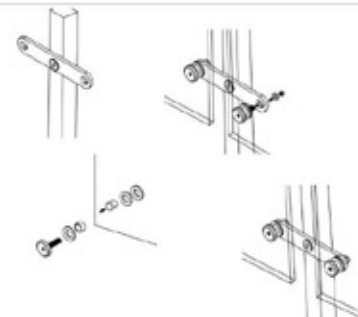
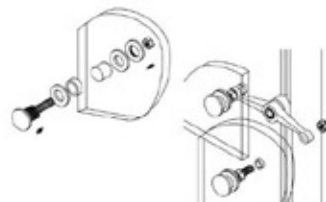
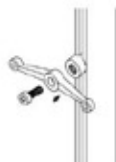
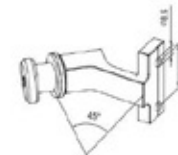



Material: SS304, SS316 ■ Finish: satin finish (S), polish finish (P)



**BJ-01**

Item NO	L	H	T
BJ-01-504025-0(flat)	50	40	25
BJ-01-634527-0(flat)	63	45	27



**BJ-02**

Item NO	L	H	T	Ø
BJ-02-504025-381	50	40	26	38.1
BJ-02-504025-424	50	40	25	42.4
BJ-02-504025-508	50	40	26	50.8
BJ-02-634527-381	63	45	27	38.1
BJ-02-634527-424	63	45	27	42.4
BJ-02-634527-483	63	45	27	48.3
BJ-02-634527-508	63	45	27	50.8



**BJ-03**

Item NO	L	H	T
BJ-03-454527-0(flat)	45	45	27
BJ-03-555530-0(flat)	55	55	30

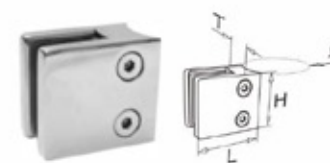

**BJ-04**

Item NO	L	H	T	Ø
BJ-04-454527-381	45	45	27	38.1
BJ-04-454527-424	45	45	27	42.4
BJ-04-454527-483	45	45	27	48.3
BJ-04-454527-508	45	45	27	50.8

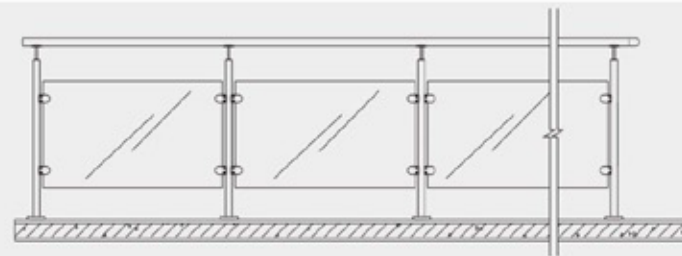

Material: SS304, SS316 Finish: satin finish (S), polish finish(P)



BJ-05			
Item NO	L	Ø	
BJ-05-172-50	172	50	
BJ-05-172-45	172	45	



BJ-06			
Item NO	L	Ø	
BJ-06-95-50	95	50	
BJ-05-95-45	95	45	



BJ-07	
Item NO	Ø
BJ-07-50	50

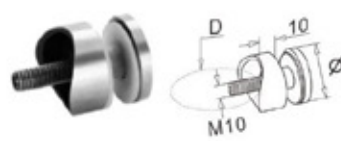

BJ-08		
Item NO	Ø	D
BJ-08-381	40	38,1
BJ-08-508	40	50,8



BJ-09			
Item NO	L	H	T
BJ-09-534325-0(flat)	53	43	25

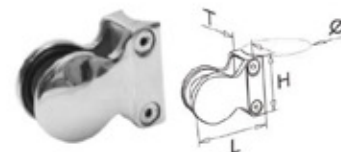

BJ-10				
Item NO	L	H	T	Ø
BJ-10-534325-381	53	43	25	38,1
BJ-10-534325-508	53	43	25	50,8

Material: SS304, SS316 Finish: satin finish (S), polish finish(P)



BJ-11			
Item NO	L	H	T
BJ-11-625327-0(flat)	62	53	27
BJ-11-605426-0(flat)	60	54	26 (Zinc alloy)

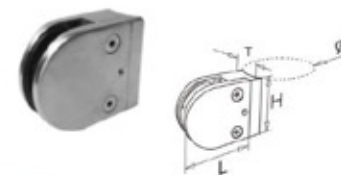

BJ-12				
Item NO	L	H	T	Ø
BJ-12-625327-381	62	53	27	38,1
BJ-12-625327-508	62	53	27	50,8
BJ-12-605426-381	60	54	26	38,1 (Zinc alloy)
BJ-12-605426-508	60	54	26	50,8 (Zinc alloy)



BJ-13 zinc with nickle/chrome plated			
Item NO	L	H	T
BJ-13-634527-0(flat)	63	45	27



BJ-14 zinc with nickle/chrome plated				
Item NO	L	H	T	Ø
BJ-14-634527-381	63	45	27	38,1
BJ-14-634527-424	63	45	27	42,4
BJ-14-634527-508	63	45	27	50,8



Material: SS304, SS316 Finish: satin finish (S), polish finish(P)



Item NO	L	H	T
BJJ-15-554230-0(flat)	55	42	30

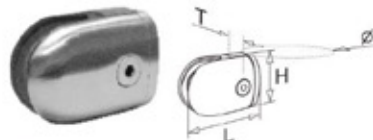

Item NO	L	H	T	Ø
BJJ-16-554230-381	55	42	30	38.1

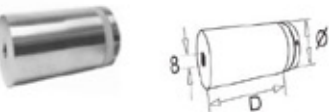

Item NO	Ø	D
BJJ-17-3838	38	38
BJJ-17-5050	50	50
BJJ-17-4525	45	25
BJJ-17-4538	45	38
BJJ-17-4550	45	50

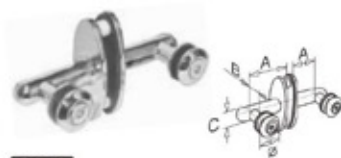

Item NO	Ø	A	B	C
BJJ-18-50	50	82	56	32
BJJ-18-33	33	57.5	39	20

Material: SS304, SS316 Finish: satin finish (S), polish finish(P)



Item NO	Ø	H
BJJ-19-3830	38	30
BJJ-19-5030	50	30
BJJ-19-5050	50	50



Item NO	Ø	H
BJJ-20-4025	40	25
BJJ-20-4050	40	50
BJJ-20-6050	60	50



Item NO	L	H	T	Ø
BJJ-21-524525-0	52	45	25	0
BJJ-21-524525-381	52	45	25	38.1
BJJ-21-524525-424	52	45	25	42.4
BJJ-21-524525-008	52	45	25	50.8
BJJ-21-634527-0	63	45	27	0
BJJ-21-634527-381	63	45	27	38.1
BJJ-21-634527-424	63	45	27	42.4
BJJ-21-634527-508	63	45	27	50.8

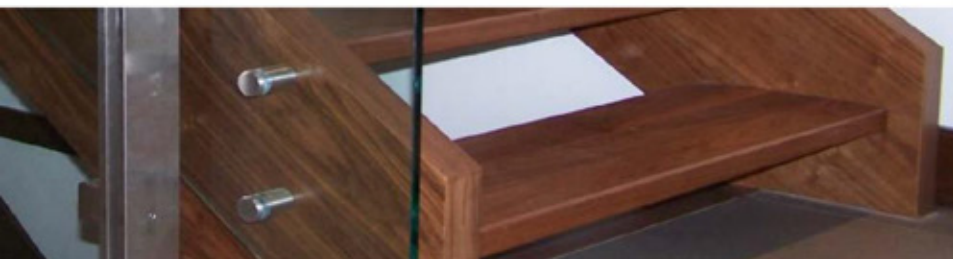

Material: SS304, SS316 Finish: satin finish (S), polish finish(P)



**BJ-22** zinc with SS cover

Item NO	L	H	T	φ
BJ-22-684629-0	66	46	29	0
BJ-22-684629-381	66	46	29	38.1
BJ-22-684629-424	66	46	29	42.4
BJ-22-684629-508	66	46	29	50.8



**BJ-23**

Item NO	L	H	T	φ
BJ-23-684530-0	66	45	30	0
BJ-23-684530-424	66	45	30	42.4
BJ-23-684530-508	66	45	30	50.8
BJ-23-684530-762	66	45	30	76.2

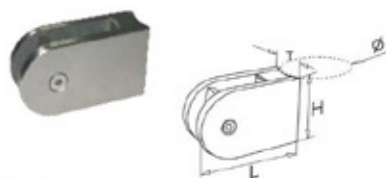

**BJ-24**

Item NO	L	H	T	φ
BJ-24-855929-45	66	50	29	45



**BJ-25** zinc

Item NO	L	H	T	φ
BJ-25-855929-45	66	50	29	45



**BJ-26**

Item NO	φ
BJ-26-45	45



**BJ-27**

Item NO	φ
BJ-27-45	45

Material: SS304, SS316 Finish: satin finish (S), polish finish(P)



**BJ-28**

Item NO	φ	L
BJ-28-381	38.1	200
BJ-28-508	50.8	200

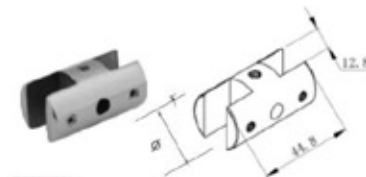

**BJ-29**

Item NO	φ
BJ-29	25



**BJ-30**

Item NO	φ	L
BJ-30	50	27



**BJ-31**

Item NO	A
BJ-31-4545	45



**BJ-32**

Item NO	φ
BJ-32-50	50

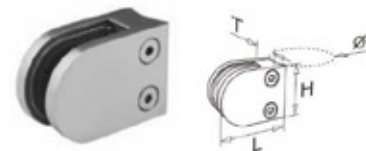

**BJ-33**

Item NO	L	H	T	φ
BJ-33-674528-424	67	45	28	42.4





Material: SS304, SS316 Finish: satin finish (S), polish finish(P)



**BJ-34**

Item NO	L	H	T	φ
BJ-34-0	45	45	25	0
BJ-34-381	45	45	25	38.1
BJ-34-508	45	45	25	50.8



**BJ-49**

Item NO	φ
BJ-49-175-30	50.8



**BJ-57**

Item NO	L	H	T
BJ-57-555536-0	55	55	36

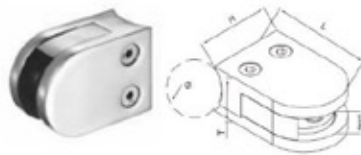

**BJ-58**

Item NO	L	H	T	φ
BJ-58-704830-424	70	48	30	42.4

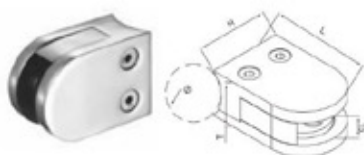

**BJ-59** zinc with nickel/chrome plated

Item NO	L	H	T	φ
BJ-59-704830-424	70	48	30	42.4



**BJ-60**

Item NO	L	H	T	φ
BJ-60-504525-508	50	45	25	50.8

Material: SS304, SS316 Finish: satin finish (S), polish finish(P)

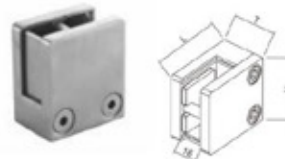

**BJ-61**

Item NO	L	H	T
BJ-61-504530-0	50	45	30



**BJ-63**

Item NO	φ
BJ-63-424	42.4

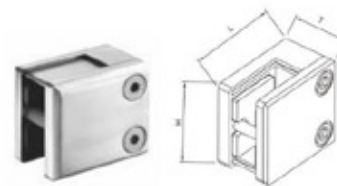

**BJ-64**

Item NO	L	H	T
BJ-64-504530-0	50	45	30



**BJ-65**

Item NO	φ	H
BJ-65-5015	50	15
BJ-65-5022	50	22
BJ-65-5035	50	30



**BJ-66**

Item NO
BJ-66-10040

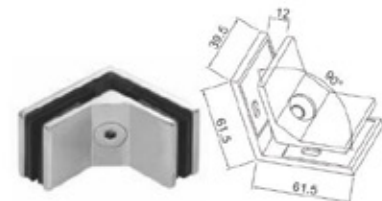

**BJ-67**

Item NO
BJ-67-5240



Material: SS304, SS316 Finish: satin finish (S), polish finish(P)

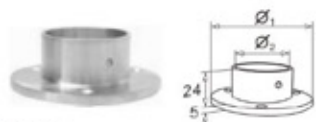

Item NO	$\phi_1$	$\phi_2$
FL-01-18	16	50
FL-01-19	19	50
FL-01-254	25.4	53
FL-01-381	38.1	100
FL-01-424	42.4	80
FL-01-445	44.5	80
FL-01-483	48.3	100
FL-01-508	50.8	100
FL-01-635	63.5	114
FL-01-762	76.2	120



Item NO	$\phi$
FL-02-483	48.3

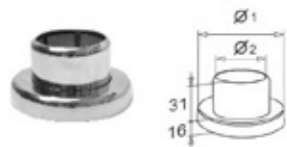

Item NO	$\phi_1$	$\phi_2$
FL-03-254	54	25.4
FL-03-381	82	38.1
FL-03-424	87	42.4
FL-03-508	94	50.8

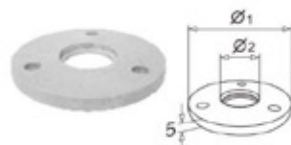

Item NO	$\phi_1$	$\phi_2$
FL-04-381	80	38.1
FL-04-381	87	38.1
FL-04-424	87	42.4
FL-04-508	98	50.8
FL-04-635	98	63.5
FL-04-762	115	76.2

FL-03

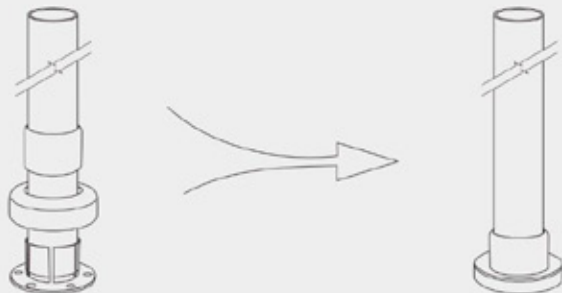

Material: SS304, SS316 Finish: satin finish (S), polish finish(P)

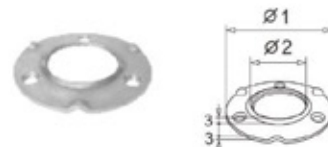

Item NO	$\phi_1$	$\phi_2$
FL-05-127	65	12.7
FL-05-19	65	19
FL-05-254	65	25.4
FL-05-318	80	38.1
FL-05-381	80	38.1
FL-05-424	100	42.4
FL-05-483	100	48.3
FL-05-508	100	50.8



Item NO	$\phi$
FL-06-381	38.1
FL-06-508	50.8



Item NO	$\phi_1$	$\phi_2$	H
FL-07-381	75	38.1	28
FL-07-508	85	50.8	30



Item NO	$\phi$
FL-08-508	50.8



Item NO	$\phi$
FL-09-381	38.1
FL-09-424	42.4
FL-09-508	50.8

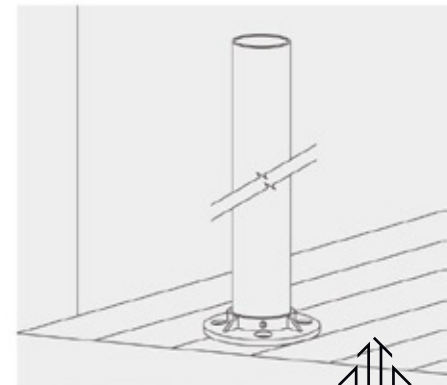

■ Material: SS304, SS316 ■ Finish: satin finish (S), polish finish(P)



FL-10			
Item NO	A	B	C
FL-10-4040	40×40	85	59
FL-10-5050	50×50	100	80

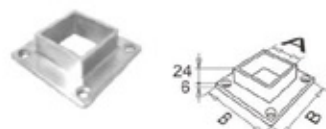

FL-11			
Item NO	A	B	
FL-11-2020	20×20	50×50	
FL-11-2525	25×25	50×50	
FL-11-3030	30×30	60×60	
FL-11-4040	40×40	80×80	
FL-11-5050	50×50	100×100	



FL-12	
Item NO	A
FL-12-4040	40×40
FL-12-5050	50×50



FL-13	
Item NO	∅
FL-13-381	38.1
FL-13-424	42.4
FL-13-483	48.3
FL-13-508	50.8

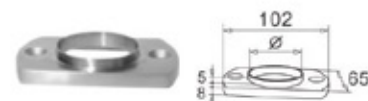

FL-14	
Item NO	∅
FL-14-381	38.1
FL-14-424	42.4
FL-14-483	48.3
FL-14-508	50.8



FL-15	
Item NO	∅
FL-15-381	38.1
FL-15-424	42.4
FL-15-483	48.3
FL-15-508	50.8



FL-16		
Item NO	A	B
FL-16-4040	40×40	78×78
FL-16-5050	50.8×50.8	100×100



FL-17		
Item NO	∅	L
FL-17-424	42.4	69.2
FL-17-381	38.1	69.2
FL-17-508	50.8	69.2

■ Material: SS304, SS316 ■ Finish: satin finish (S), polish finish(P)

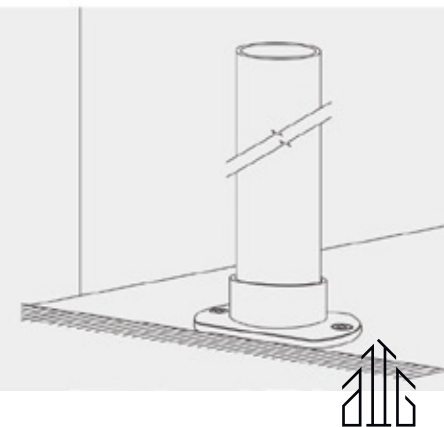

Material: SS304, SS316 Finish: satin finish (S), polish finish(P)

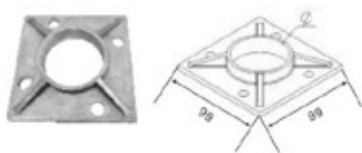

FL-19		
Item NO	∅	
FL-19-508	50,8	

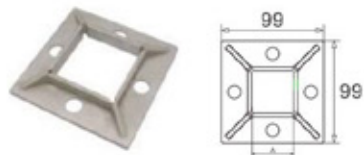

FL-20	
Item NO	A
FL-20-4040	40x40



FL-21		
Item NO	∅A	∅B
FL-21-381	38,1	65
FL-21-508	50,8	76

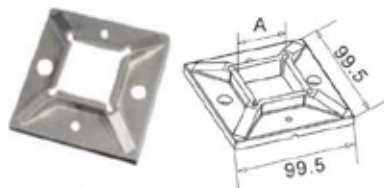

FL-22	
Item NO	A
FL-22-4040	40x40



FL-23		
Item NO	∅A	∅B
FL-23-254	50	25,4
FL-23-381	60	38,1
FL-23-508	76	50,8



FL-24			
Item NO	∅	H	T
FL-24-381	38,1	70	6
FL-24-424	42,4	70	6
FL-24-508	50,8	70	6

Material: SS304, SS316 Finish: satin finish (S), polish finish(P)

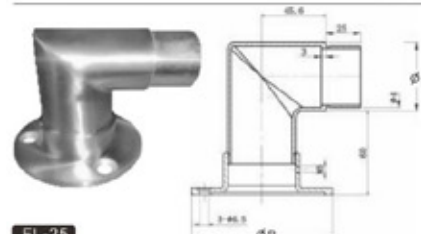

FL-25		
Item NO	∅A	∅B
FL-25-483	48,3	100

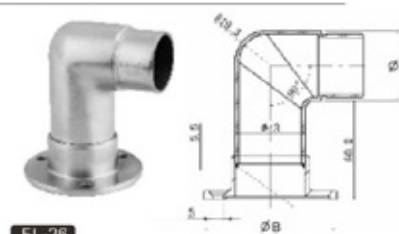

FL-26		
Item NO	∅A	∅B
FL-26-424	42,4	80

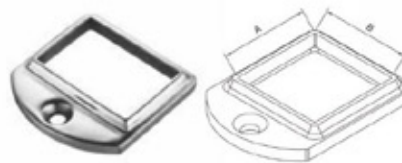

FL-27		
Item NO	A	B
FL-27-2521	25	21
FL-27-5025	50	25
FL-27-6040	60	40



FL-28	
Item NO	∅
FL-28-508	50,8





Material: SS304, SS316 Finish: satin finish (S), polish finish(P)



**FG-01**

Item NO	ø
FG-01-381	38,1
FG-01-424	42,4
FG-01-483	48,3
FG-01-508	50,8

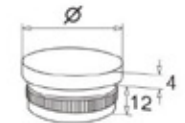

**FG-02**

Item NO	ø
FG-02-381	38,1
FG-02-424	42,4
FG-02-483	48,3
FG-02-508	50,8

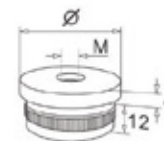

**FG-03**

Item NO	ø	M
FG-03-381	38,1	8
FG-03-424	42,4	8
FG-03-483	48,3	8
FG-03-508	50,8	8



**FG-04**

Item NO	ø
FG-04-381	38,1
FG-04-424	42,4
FG-04-483	48,3
FG-04-508	50,8

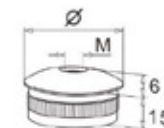

**FG-05**

Item NO	ø	M
FG-05-381	38,1	8
FG-05-424	42,4	8
FG-05-483	48,3	8
FG-05-508	50,8	8

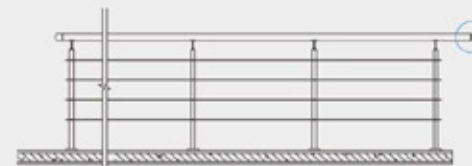



Material: SS304, SS316 Finish: satin finish (S), polish finish(P)



FG-06	
Item NO	ø
FG-06-381	38,1
FG-06-424	42,4
FG-06-483	48,3
FG-06-508	50,8



FG-07		
Item NO	ø	M
FG-07-381	38,1	8
FG-07-424	42,4	8
FG-07-483	48,3	8
FG-07-508	50,8	8

Material: SS304, SS316 Finish: satin finish (S), polish finish(P)



FG-08	
Item NO	ø
FG-08-381	38,1
FG-08-424	42,4
FG-08-483	48,3
FG-08-508	50,8



FG-09	
Item NO	ø
FG-09-254	25,4
FG-09-381	38,1
FG-09-424	42,4
FG-09-483	48,3
FG-09-508	50,8



FG-10	
Item NO	ø
FG-10-16	16
FG-10-254	25,4
FG-10-381	39,1
FG-10-424	42,4
FG-10-483	48,3
FG-10-508	50,8



FG-11		
Item NO	ø	D
FG-11-1220	12,5	20
FG-11-1225	12,5	25
FG-11-1230	12,5	30
FG-11-1235	12,5	35
FG-11-1625	16,5	25
FG-11-1630	16,5	30
FG-11-1635	16,5	35

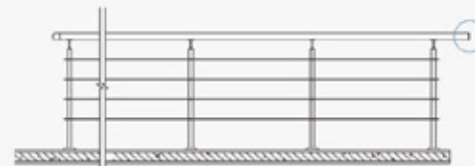
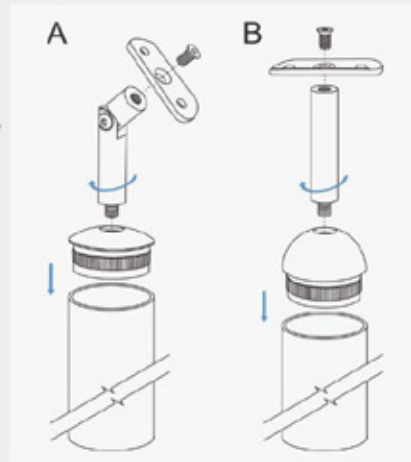
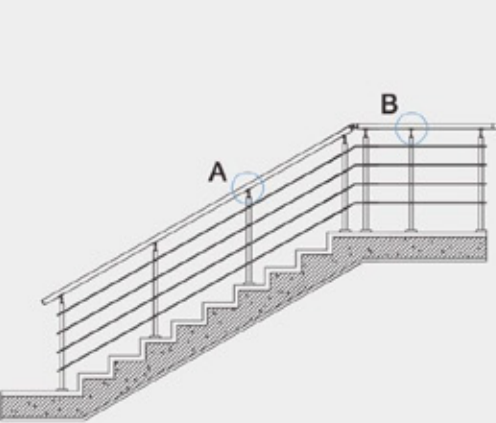

Material: SS304, SS316 Finish: satin finish (S), polish finish(P)



**FG-12**

Item NO	Ø
FG-12-381	38,1
FG-12-424	42,4
FG-12-483	48,3
FG-12-508	50,8



**FG-13**

Item NO	Ø
FG-13-254	25,4
FG-13-381	38,1
FG-13-424	42,4
FG-13-483	48,3
FG-13-508	50,8



**FG-14**

Item NO	A	B
FG-14-5336	53	36



**FG-15**

Item NO	A
FG-15-4040	40×40
FG-15-5050	50×50

Material: SS304, SS316 Finish: satin finish (S), polish finish(P)



**FG-16**

Item NO	Ø	H
FG-16-12	12	14
FG-16-16	16	19



**FG-17**

Item NO	Ø
FG-17-381	38,1
FG-17-424	42,4
FG-17-508	50,8



**FG-18**

Item NO	Ø
FG-18-12	12
FG-18-16	16



**FG-19**

Item NO
FG-19-4040

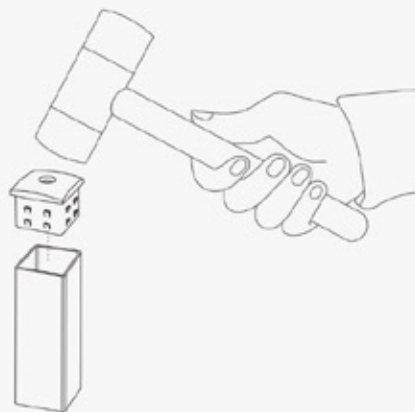
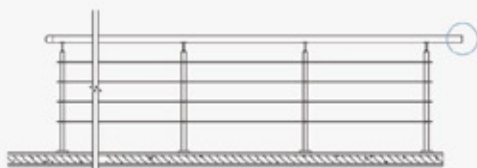

Material: SS304, SS316 Finish: satin finish (S), polish finish(P)

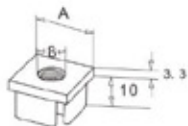

**FG-20**

Item NO	A
FG-20-1414	14x14
FG-20-2020	20x20

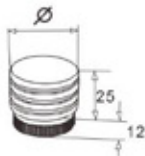

**FG-21**

Item NO	Ø
FG-21-424	42,4

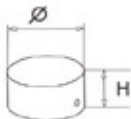

**FG-22**

Item NO	Ø	H
FG-22-50	50	25

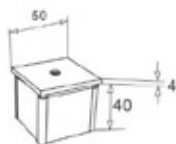

**FG-23**

Item NO	
FG-23-5050	

Material: SS304, SS316 Finish: satin finish (S), polish finish(P)

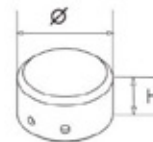

**FG-24**

Item NO	Ø	H
FG-24-424	42,4	30
FG-24-508	50,8	43

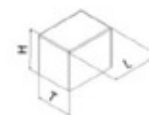

**FG-25**

Item NO	L	T	H
FG-25-2513	25	13	22

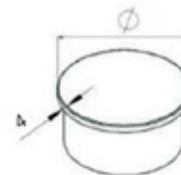

**FG-26**

Item NO	Ø
FG-26-254	25,4
FG-26-835	83,5
FG-26-782	78,2
FG-26-1016	101,6

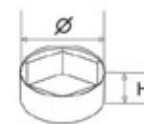

**FG-27**

Item NO	Ø	H
FG-27	21	12

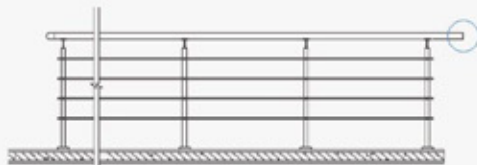

Material: SS304, SS316 Finish: satin finish (S), polish finish(P)



Item NO	$\phi$	H
FG-28-254	25.4	12



Item NO	$\phi A$	$\phi B$
FG-29-12W	12	90
FG-29-16W	16	90
FG-29-12Y	12	30
FG-29-16Y	16	30

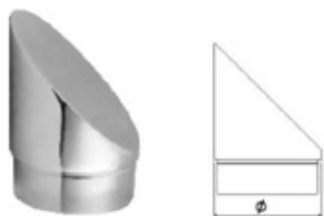

Item NO	$\phi$
FG-30-762	76.2



Item NO	A
FG-31-4040	40x40



Item NO	$\phi$
FG-32-508	50.8



Item NO	$\phi$	H
FG-33-16	16	10
FG-33-381	38.1	7
FG-33-508	50.8	9

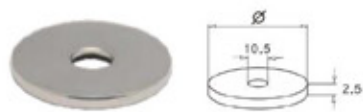

Item NO	$\phi$
FG-34-381	38.1

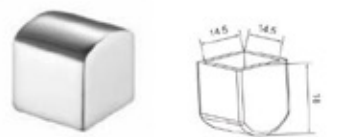

Item NO
FG-35-1414

Material: SS304, SS316 Finish: satin finish (S), polish finish(P)

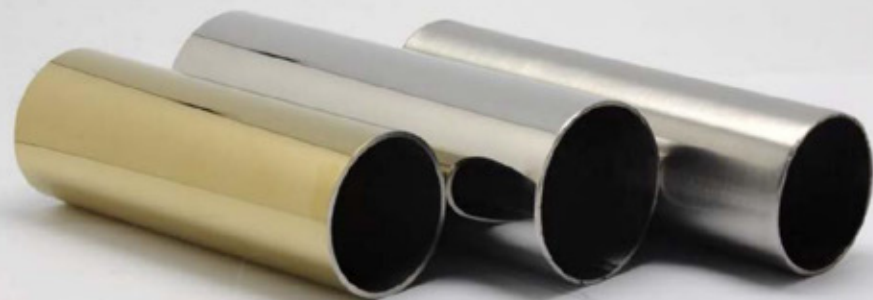

Material: SS304, SS316 Finish: satin finish (S), polish finish(P)



**JT-01** closed right/closed left

Item NO	D	φ
JT-01-12-0Z	12	
JT-01-12-381Z	12	38.1
JT-01-12-424Z	12	42.4
JT-01-12-508Z	12	50.8
JT-01-16-0Y	16	
JT-01-16-381Y	16	38.1
JT-01-16-424Y	16	42.4
JT-01-16-508Y	16	50.8



**JT-02**

Item NO	D	φ
JT-02-12-0(flat)	12	0
JT-02-12-381	12	38.1
JT-02-12-424	12	42.4
JT-02-12-483	12	48.3
JT-02-12-508	12	50.8
JT-02-12-603	12	60.3
JT-02-16-0(flat)	16	0
JT-02-16-381	16	38.1
JT-02-16-424	16	42.4
JT-02-16-483	16	48.3
JT-02-16-508	16	50.8
JT-02-16-603	16	60.3

Material: SS304, SS316 Finish: satin finish (S), polish finish(P)



**JT-03**

Item NO	φ
JT-03-12	12
JT-03-16	16



**JT-04**

Item NO	A	B
JT-04-2513	25	13



**JT-05**

Item NO	φa	φb
JT-05-12-12	12	12
JT-05-12-16	12	16
JT-05-16-16	16	16



**JT-06**

Item NO	φ
JT-06-12	12
JT-06-16	16

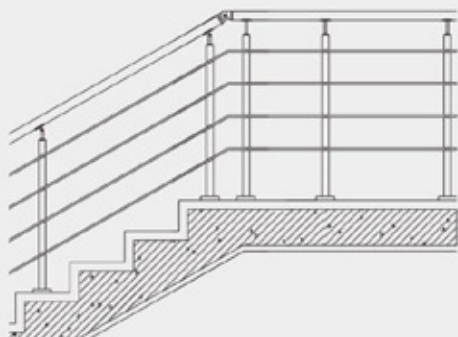



Material: SS304, SS316 Finish: satin finish (S), polish finish(P)



**JT-07**

Item NO	D
JT-07-25-0(flat)	25



**JT-08**

Item NO	D	Ø
JT-08-381	25	38.1
JT-08-424	25	42.4
JT-08-483	25	48.3
JT-08-508	25	50.8
JT-08-603	25	60.3



**JT-09**

Item NO	Ø
JT-09-12	12
JT-09-16	16

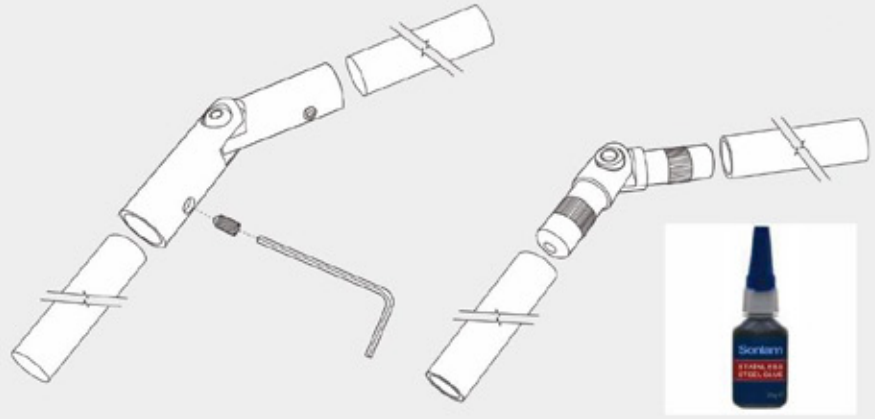

Material: SS304, SS316 Finish: satin finish (S), polish finish(P)



**JT-10**

Item NO	Ø
JT-10-12	12
JT-10-16	16



**JT-11**

Item NO	Ø
JT-11-12	12
JT-11-16	16

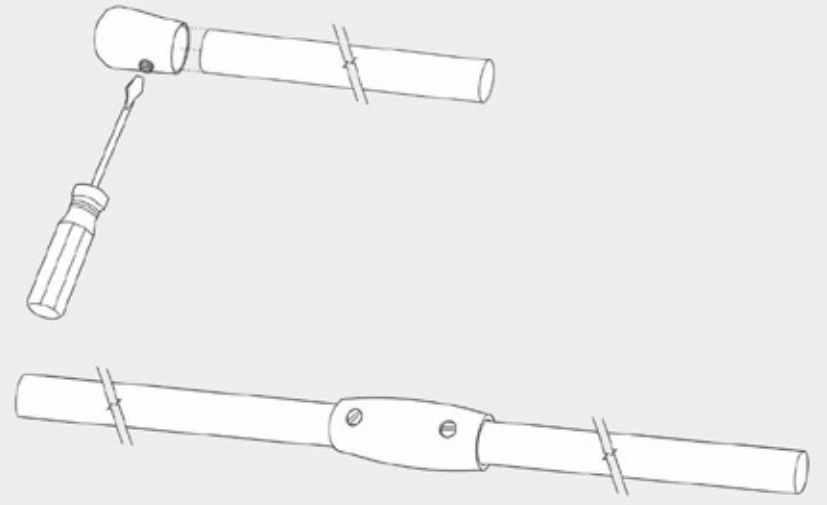

Material: SS304, SS316 Finish: satin finish (S), polish finish(P)



JT-12	
Item NO	Ø
JT-12-12	12
JT-12-16	16



JT-13	
Item NO	Ø
JT-13-12	12
JT-13-16	16



JT-14	
Item NO	Ø
TJ-14-381	38.1
TJ-14-424	42.4
TJ-14-483	48.3
TJ-14-508	50.8



JT-15	
Item NO	Ø
JT-15-12	12
JT-15-16	16



JT-16			
Item NO	Ø	D	A
JT-16-2212-424	42.4	22	12
JT-16-2214-424	42.4	22	14



Material: SS304, SS316 Finish: satin finish (S), polish finish(P)

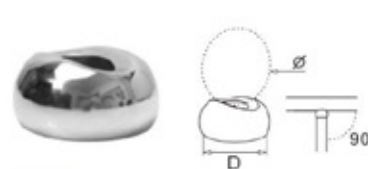

JT-17		
Item NO	D	Ø
JT-17-254-424-90	25.4	42.4
JT-17-381-424-90	38.1	42.4
JT-17-424-424-90	42.4	42.4
JT-17-508-508-90	50.8	50.8

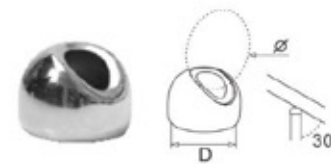

JT-18		
Item NO	D	Ø
JT-18-254-424-30	25.4	42.4
JT-18-381-424-30	38.1	42.4
JT-18-424-424-30	42.4	42.4
JT-18-508-508-30	50.8	50.8

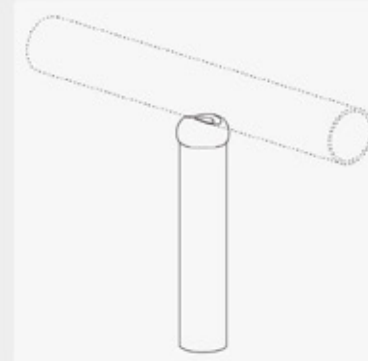
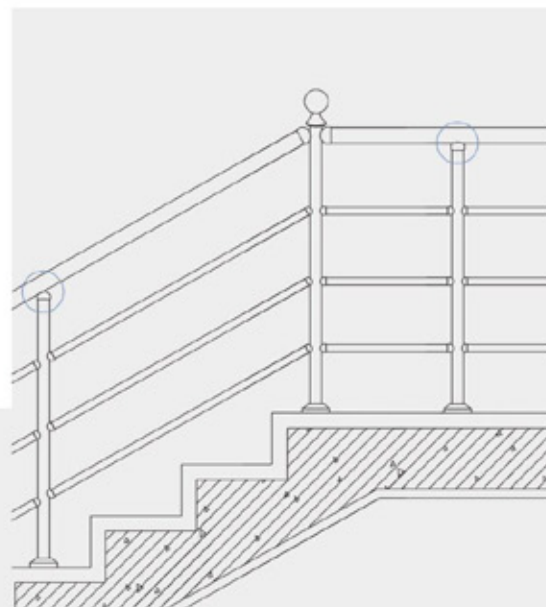

Material: SS304, SS316 Finish: satin finish (S), polish finish(P)



JT-19	
Item NO	Ø
JT-19-12	12
JT-19-16	16



JT-20		
Item NO	Ø	M
JT-20-816	8	16



JT-25		
Item NO	Ø	L
JT-25-16	16	25



JT-26	
Item NO	Ø
TJ-26-424	42.4



JT-21		
Item NO	Ø	H
JT-21-337	30	60
JT-21-424	38	60



JT-22	
Item NO	Ø
JT-22-424	42.4



JT-27	
Item NO	Ø
JT-27-12	12
JT-27-127	12.7
JT-27-16	16
JT-27-19	19
JT-27-254	25.4



JT-28		
Item NO	ØA	ØB
JT-28-127		12.7
JT-28-127-508	50.8	12.7
JT-28-16		16
JT-28-16-508	50.8	16



JT-23		
Item NO	ØA	ØB
JT-23-12	12	38.1
JT-23-16	16	50.8
JT-23-19	19	50.8



JT-24		
Item NO	Ø	L
JT-24-508	50.8	60.2



JT-29		
Item NO	Ø	L
JT-29-16	16	21



JT-30		
Item NO	ØA	ØB
JT-30-12-424	12	42.4



TECHNICS ORIGINATES FROM SPECIFICS  
SPECIFICS FORMS PERFECTION



Material: SS304, SS316 Finish: satin finish (S), polish finish(P)

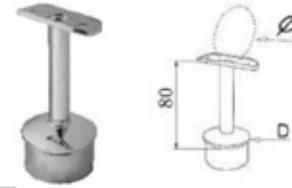

**TJ-01**

Item NO	D	∅
TJ-01-381-381	38,1	38,1
TJ-01-381-508	38,1	50,8
TJ-01-424-424	42,4	42,4
TJ-01-424-483	42,4	48,3
TJ-01-483-483	48,3	48,3
TJ-01-508-508	50,8	50,8



**TJ-02**

Item NO	D	∅
TJ-02-381-381	38,1	38,1
TJ-02-381-508	38,1	50,8
TJ-02-424-424	42,4	42,4
TJ-02-424-483	42,4	48,3
TJ-02-483-483	48,3	48,3
TJ-02-508-508	50,8	50,8



**TJ-03**

Item NO	D	∅
TJ-03-381-381	38,1	38,1
TJ-03-381-508	38,1	50,8
TJ-03-424-424	42,4	42,4
TJ-03-483-483	48,3	48,3
TJ-03-508-508	50,8	50,8



**TJ-04**

Item NO	D
TJ-04-381-0(flat)	38,1
TJ-04-424-0(flat)	42,4
TJ-04-483-0(flat)	48,3
TJ-04-508-0(flat)	50,8



To stick with glue



Material: SS304, SS316 Finish: satin finish (S), polish finish(P)



TJ-05		
Item NO	D	φ
TJ-05-381-381	38.1	38.1
TJ-05-381-508	38.1	50.8
TJ-05-424-424	42.4	42.4
TJ-05-424-483	42.4	48.3
TJ-05-483-483	48.3	48.3
TJ-05-508-508	50.8	50.8



TJ-06		
Item NO	φ	
TJ-06-381	38.1	
TJ-06-424	42.4	
TJ-06-483	48.3	
TJ-06-508	50.8	

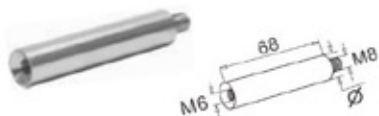

TJ-07		
Item NO	φ	
TJ-07-6-6	14	

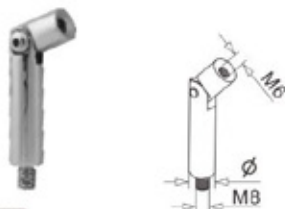

TJ-08		
Item NO	φ	
TJ-08-6-6	14	



TJ-09		
Item NO	φ	
TJ-09-0 (flat)	0	
TJ-09-381	38.1	
TJ-09-424	42.4	
TJ-09-483	48.3	
TJ-09-508	50.8	

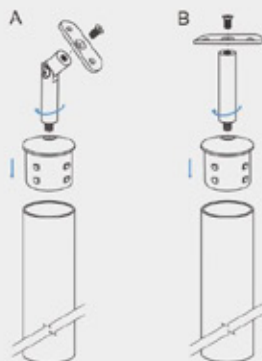

Material: SS304, SS316 Finish: satin finish (S), polish finish(P)



TJ-10		
Item NO	φA	φB
TJ-10-381-381	38.1	38.1
TJ-10-381-508	38.1	50.8
TJ-10-424-424	42.4	42.4
TJ-10-424-483	42.4	48.3
TJ-10-508-508	50.8	50.8

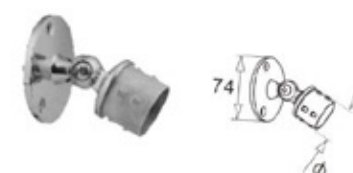

TJ-11		
Item NO	φ	
TJ-11-381	38.1	
TJ-11-424	42.4	
TJ-11-483	48.3	
TJ-11-508	50.8	



TJ-12		
Item NO	φ	
TJ-12-381	38.1	
TJ-12-424	42.4	
TJ-12-483	48.3	
TJ-12-508	50.8	



TJ-13		
Item NO	D	φ
TJ-13-381-381	38.1	38.1
TJ-13-381-508	38.1	50.8
TJ-13-424-424	42.4	42.4
TJ-13-424-483	42.4	48.3
TJ-13-483-483	48.3	48.3
TJ-13-508-508	50.8	50.8

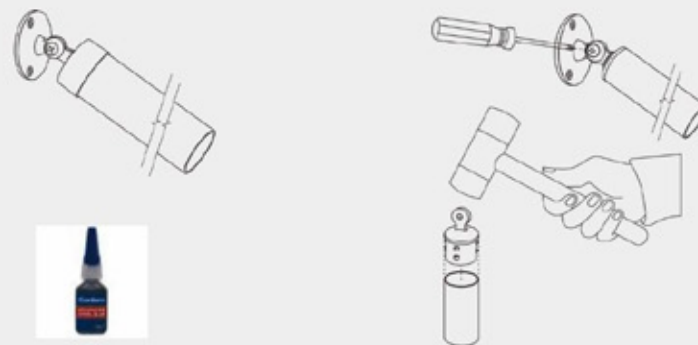



Material: SS304, SS316 Finish: satin finish (S), polish finish(P)



TJ-14		
Item NO	M	∅
TJ-14-01	6	70



TJ-15	
Item NO	∅
TJ-15-01	12



TJ-16	
Item NO	∅
TJ-16-0 (flat)	0
TJ-16-381	38.1
TJ-16-424	42.4
TJ-16-483	48.3
TJ-16-508	50.8



TJ-17	
Item NO	∅
TJ-17-0 (flat)	0
TJ-17-381	38.1
TJ-17-424	42.4
TJ-17-483	48.3
TJ-17-508	50.8



Material: SS304, SS316 Finish: satin finish (S), polish finish(P)



TJ-18	
Item NO	∅
TJ-18-381	38.1
TJ-18-424	42.4
TJ-18-483	48.3
TJ-18-508	50.8



TJ-19	
Item NO	∅
TJ-19-0 (flat)	0
TJ-19-381	38.1
TJ-19-424	42.4
TJ-19-483	48.3
TJ-19-508	50.8

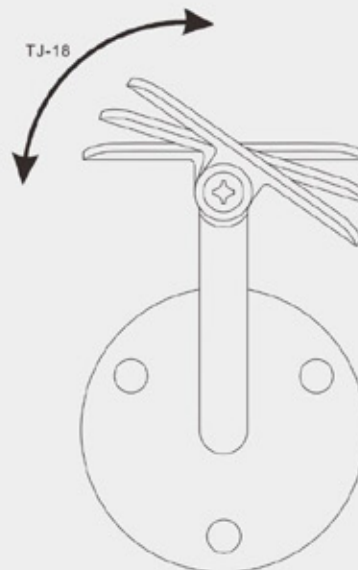

Material: SS304, SS316 Finish: satin finish (S), polish finish(P)



Item NO	∅
TJ-20-0 (flat)	0
TJ-20-381	38.1
TJ-20-424	42.4
TJ-20-483	48.3
TJ-20-508	50.8



Item NO	∅
TJ-21-381	38.1
TJ-21-424	42.4
TJ-21-483	48.3
TJ-21-508	50.8

Material: SS304, SS316 Finish: satin finish (S), polish finish(P)



Item NO	∅
TJ-22-0 (flat)	0
TJ-22-381	38.1
TJ-22-424	42.4
TJ-22-483	48.3
TJ-22-508	50.8



Item NO	D
TJ-23-381	38.1
TJ-23-424	42.4

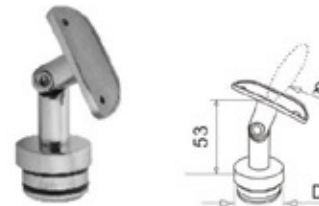

Item NO	D	∅
TJ-24-381-508	38.1	50.8
TJ-24-424-483	42.4	48.3



Item NO	D	∅
TJ-25-381-508	38.1	50.8
TJ-25-424-483	42.4	48.3

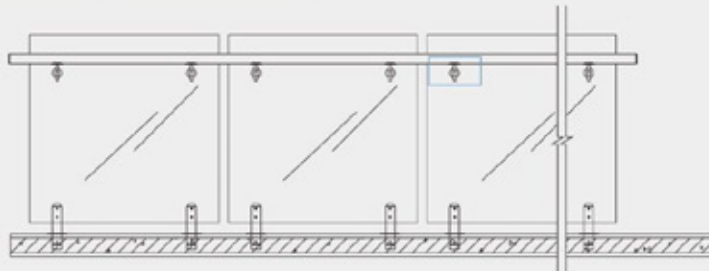
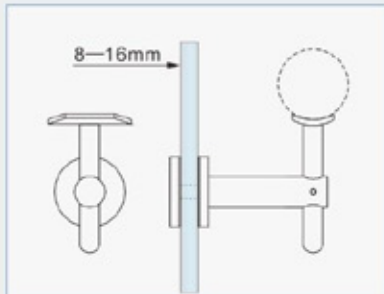

Material: SS304, SS316 Finish: satin finish (S), polish finish(P)



**TJ-26**

Item NO	Ø
TJ-26-381	38.1
TJ-26-424	42.4
TJ-26-483	48.3



**TJ-27**

Item NO	Øa	Øb
TJ-27-381-381	38.1	38.1
TJ-27-381-508	38.1	50.8
TJ-27-424-424	42.4	42.4
TJ-27-424-483	42.4	48.3
TJ-27-508-508	50.8	50.8



**TJ-28**

Item NO	Ø
TJ-28-381	38.1
TJ-28-424	42.4
TJ-28-483	48.3
TJ-28-508	50.8



**TJ-29**

Item NO	Ø
TJ-29-381	38.1
TJ-29-424	42.4
TJ-29-508	50.8

Material: SS304, SS316 Finish: satin finish (S), polish finish(P)



**TJ-30**

Item NO	D	Ø
TJ-30-381-381	38.1	38.1
TJ-30-381-508	38.1	50.8
TJ-30-424-424	42.4	42.4
TJ-30-424-483	42.4	48.3
TJ-30-483-483	48.3	48.3
TJ-30-508-508	50.8	50.8



**TJ-31**

Item NO	ØA	ØB
TJ-31-381-508	38.1	50.8
TJ-31-508-508	50.8	50.8



**TJ-32**

Item NO	D
TJ-32-381	38.1
TJ-32-424	42.4
TJ-32-483	48.3
TJ-32-508	50.8



**TJ-33**

Item NO	ØA	ØB
TJ-33-381-381	38.1	38.1
TJ-33-381-508	38.1	50.8
TJ-33-424-424	42.4	42.4
TJ-33-424-483	42.4	48.3
TJ-33-508-508	50.8	50.8

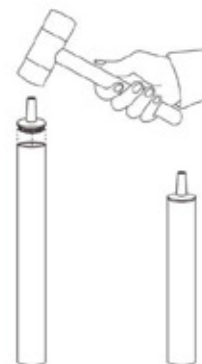

Material: SS304, SS316 Finish: satin finish (S), polish finish(P)

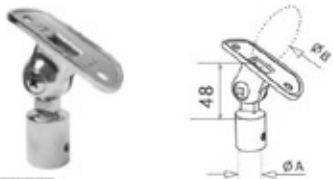

TJ-34		
Item NO	Ø A	Ø B
TJ-34-12-254	12	25.4
TJ-34-12-381	12	38.1
TJ-34-12-424	12	42.4
TJ-34-12-508	12	50.8



TJ-35		
Item NO	Øa	Øb
TJ-35-381-381	38.1	38.1
TJ-35-381-508	38.1	50.8
TJ-35-424-424	42.4	42.4
TJ-35-424-483	42.4	48.3
TJ-35-483-483	48.3	48.3
TJ-35-508-508	50.8	50.8

Material: SS304, SS316 Finish: satin finish (S), polish finish(P)



TJ-36		
Item NO	D	Ø
TJ-36-381-0	38.1	0
TJ-36-381-381	38.1	38.1
TJ-36-381-508	38.1	50.8
TJ-36-424-424	42.4	42.4
TJ-36-424-483	42.4	48.3
TJ-36-483-483	48.3	48.3
TJ-36-508-508	50.8	50.8



TJ-37		
Item NO	D	Ø
TJ-37-381-381	38.1	38.1
TJ-37-381-508	38.1	50.8
TJ-37-424-424	42.4	42.4
TJ-37-424-483	42.4	48.3
TJ-37-508-508	50.8	50.8

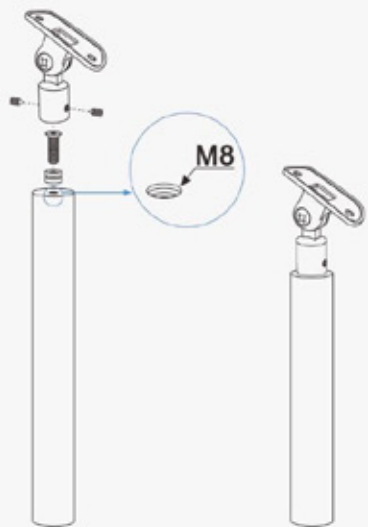

■ Material: SS304, SS316 ■ Finish: satin finish (S), polish finish(P)

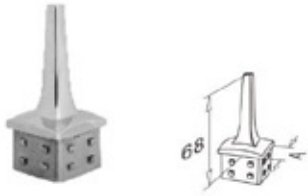

TJ-38	
Item NO	A
TJ-38-4040	40×40
TJ-38-5050	50×50



TJ-39	
Item NO	∅
TJ-39-0	0
TJ-39-424	42.4
TJ-39-508	50.8

■ Material: SS304, SS316 ■ Finish: satin finish (S), polish finish(P)



TJ-40	
Item NO	∅
TJ-40-0 (flat)	0
TJ-40-381	38.1
TJ-40-424	42.4
TJ-40-483	48.3
TJ-40-508	50.8



TJ-41	
Item NO	A
TJ-41-4040	40×40
TJ-41-5050	50×50



TJ-42	
Item NO	∅
TJ-42-01	50



TJ-43	
Item NO	∅
TJ-43-0	0
TJ-43-381	38.1
TJ-43-424	42.4
TJ-43-483	48.3
TJ-43-508	50.8

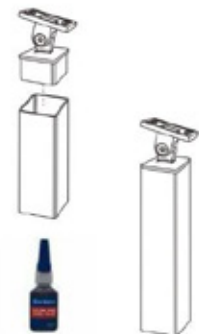
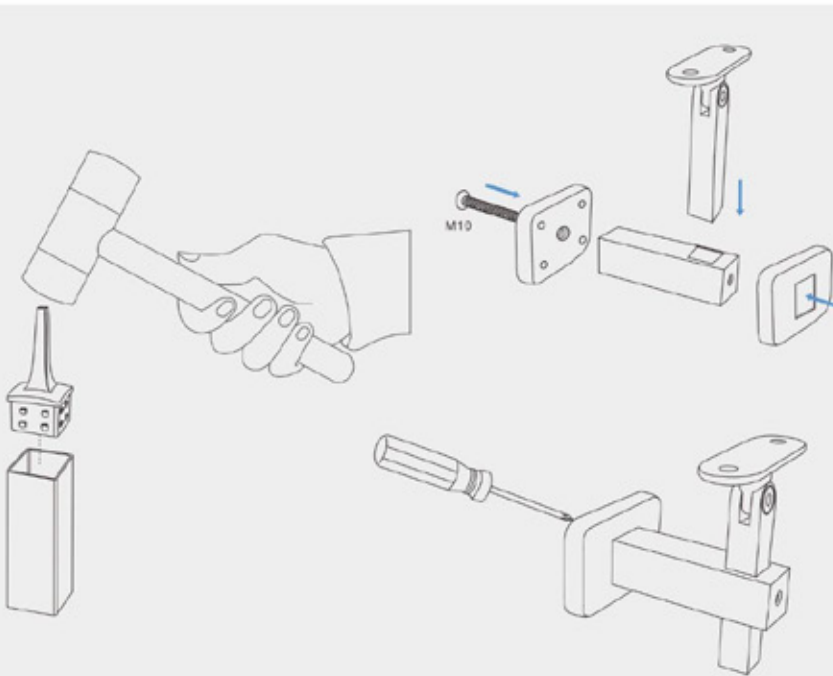



■ Material: SS304, SS316 ■ Finish: satin finish (S), polish finish(P)



**TJ-44**

Item NO	D	∅
TJ-44-381-381	38.1	38.1
TJ-44-381-508	38.1	50.8
TJ-44-424-424	42.4	42.4
TJ-44-424-483	42.4	48.3
TJ-44-483-483	48.3	48.3
TJ-44-508-508	50.8	50.8



**TJ-45**

Item NO	D	∅
TJ-45-381-381	38.1	38.1
TJ-45-381-508	38.1	50.8
TJ-45-424-424	42.4	42.4
TJ-45-424-483	42.4	48.3
TJ-45-483-483	48.3	48.3
TJ-45-508-508	50.8	50.8

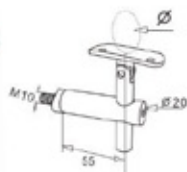

**TJ-46**

Item NO	∅
TJ-46-381	38.1
TJ-46-424	42.4
TJ-46-483	48.3
TJ-46-508	50.8



**TJ-47**

Item NO	D	∅
TJ-47-381-381	38.1	38.1
TJ-47-381-508	38.1	50.8
TJ-47-424-424	42.4	42.4
TJ-47-424-483	42.4	48.3
TJ-47-483-483	48.3	48.3
TJ-47-508-508	50.8	50.8



■ Material: SS304, SS316 ■ Finish: satin finish (S), polish finish(P)

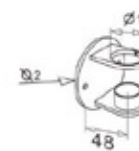

**TJ-48**

Item NO	∅1	∅2
TJ-48-381	38.1	100
TJ-48-424	42.4	100
TJ-48-508	50.8	109

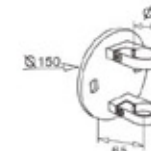

**TJ-49**

Item NO	∅
TJ-49-381	38.1
TJ-49-424	42.4
TJ-49-508	50.8



**TJ-50**

Item NO	∅
TJ-50-0	0
TJ-50-381	38.1
TJ-50-424	42.4
TJ-50-483	48.3
TJ-50-508	50.8

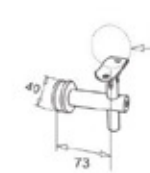

**TJ-51**

Item NO	∅
TJ-51-0	0
TJ-51-381	38.1
TJ-51-424	42.4
TJ-51-483	48.3
TJ-51-508	50.8

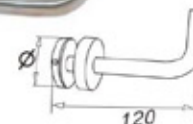

**TJ-52**

Item NO	∅
TL-52-40	40

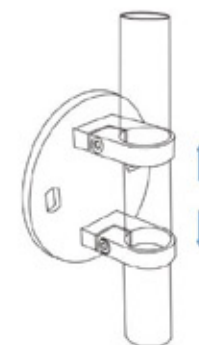

Material: SS304, SS316 Finish: satin finish (S), polish finish(P)



TJ-85	
Item NO	φ
TJ-85-381	38.1
TJ-85-508	50.8



TJ-86		
Item NO	φ	L
TJ-86-381	38.1	100
TJ-86-25-70	25	70
TJ-86-38-70	38	70
TJ-86-424-70	42.4	70
TJ-86-508-70	50.8	70

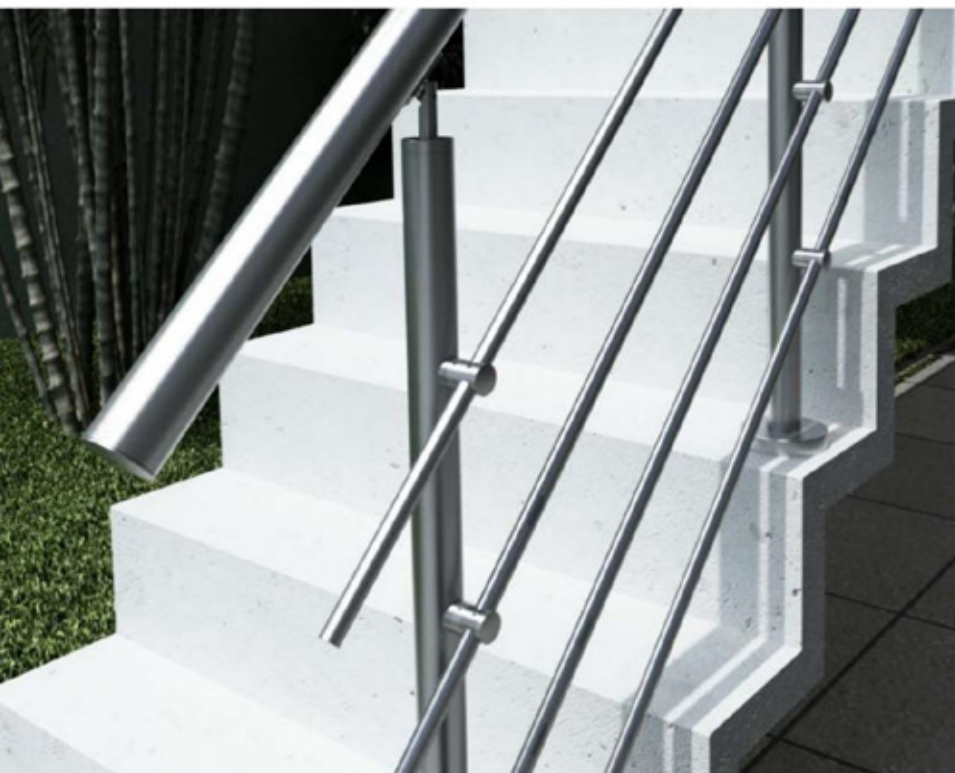

Material: SS304, SS316 Finish: satin finish (S), polish finish(P)



TJ-87		
Item NO	D	φ
TJ-87-40-508	40X40	50.8
TJ-87-40-0	40X40	0



TJ-88			
Item NO	φA	φB	H
TJ-88-508	50.8	70	178

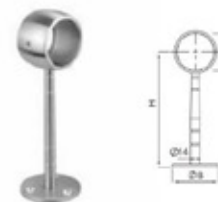

TJ-89			
Item NO	φA	φB	H
TJ-89-381-150	38.1	70	128
TJ-89-508-150	50.8	70	128
TJ-89-381-200	38.1	70	178
TJ-89-508-200	50.8	70	178



TJ-90			
Item NO	φA	φB	H
TJ-90-508	50.8	70	178



TJ-91		
Item NO	φA	φB
TJ-91-508	50.8	14



TJ-93	
Item NO	
TJ-93	



■ Material: SS304, SS316 ■ Finish: satin finish (S), polish finish(P)



TJ-94		
Item NO	D	φ
TJ-94-508-381	50.8	38.1
TJ-94-381-508	38.1	50.8



TJ-95	
Item NO	φ
TJ-95-0	14



TJ-105	
Item NO	φ
TJ-105-508-508	50.8



TJ-113		
Item NO	A	φ
TJ-113-4040-508	40X40	50.8
TJ-113-4040-0	40X40	0



TJ-96		
Item NO	φA	φB
TJ-96-508	50.8	16
TJ-96-508-14	50.8	14



TJ-97	
Item NO	φ
TJ-97-381	38.1
TJ-97-424	42.4

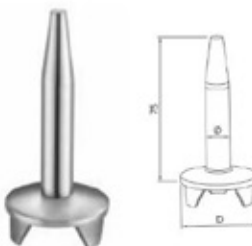

TJ-114		
Item NO	D	φ
TJ-114-381	38.1	12



TJ-115		
Item NO	D	φ
TJ-115-4040-508	40X40	50.8



TJ-98		
Item NO	D	φ
TJ-98-381-508	38.1	50.8



TJ-102	
Item NO	φ
TJ-102-381	38.1
TJ-102-0	0



TJ-116		
Item NO	D	φ
TJ-116-381	38.1	12





Material: SS304, SS316 ■ Finish: satin finish (S), polish finish(P)



**TU-01**  
Item NO      $\phi$   
TU-01-424    42.4    for 24X24mm single slot



**TU-02**  
Item NO      $\phi$   
TU-02-424    42.4    for 24X24mm single slot



**TU-03**  
Item NO      $\phi$   
TU-03-424    42.4    for 24X24mm single slot



**TU-04**  
Item NO      $\phi$   
TU-04-424    42.4    for 24X24mm single slot



**TU-05**  
Item NO      $\phi$   
TU-05-424    42.4    for 24X24mm single slot



**TU-06**  
Item NO      $\phi$   
TU-06-424    42.4    for 24X24mm single slot



**TU-07**  
Item NO      $\phi$   
TU-07-424    42.4    for 24X24mm single slot



**TU-08**  
Item NO      $\phi$   
TU-08-424    42.4    for 24X24mm single slot





Material: SS304, SS316 Finish: satin finish (S), polish finish(P)



**TU-09**  
Item NO  $\phi$   
TU-09-254 25,4 tube slot 14X14mm



**TU-10**  
Item NO A  
TU-10-40 40x40 tube slot 24X24mm



**TU-11**  
Item NO A  
TU-11-40 40x40 tube slot 24X24mm



**TU-12**  
Item NO A B  
TU-12-508254 50,8 25,4 tube slot 15X15mm



**TU-13**  
Item NO A H  
TU-13-2521 25 21 tube slot 14X14mm



**TU-14**  
Item NO A B  
TU-14-2521 25 21 tube slot 14X14mm



**TU-15**  
Item NO A H  
TU-15-2521 25 21 tube slot 14X14mm



**TU-16**  
Item NO A B  
TU-16-2521 25 21 tube slot 14X14mm

Material: SS304, SS316 Finish: satin finish (S), polish finish(P)

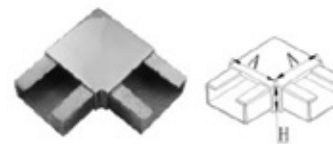

**TU-17**  
Item NO A H  
TU-17-508254 50,8 25,4 tube slot 15X15mm

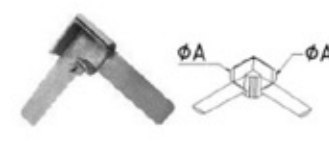

**TU-18**  
Item NO A  
TU-18-254 25,4 tube slot 14X14mm



**TU-19**  
Item NO  $\phi$   
TU-19-508 50,8 single slot 15x15mm



**TU-20**  
Item NO  $\phi$   
TU-20-508 50,8 90° double slot 15x15mm



**TU-21**  
Item NO  $\phi$   
TU-21-508 50,8 double slot 15x15mm



**TU-22**  
Item NO  $\phi$   
TU-22-508 50,8 double slot 15x15mm



**TU-23**  
Item NO  $\phi$   
TU-23-508 50,8 90° 15x15mm



**TU-24**  
Item NO L T  
TU-24-508254 50,8 25,4 tube slot 15X15mm





Material: SS304, SS316 ■ Finish: satin finish (S), polish finish (P)



**TU-25**  
Item NO       $\phi$   
TU-25-254    25.4    tube slot 14×14mm



**TU-26**  
Item NO       $\phi$   
TU-26-508    50.8    90° 15×15mm



**TU-27**  
Item NO       $\phi$   
TU-27-508    50.8    single slot 15×15mm



**TU-28**  
Item NO       $\phi$   
TU-28-508    50.8    double slot 15×15mm



**TU-29**  
Item NO       $\phi$   
TU-29-254    25.4    tube slot 14×14mm



**TU-30**  
Item NO       $\phi$   
TU-30-508    50.8    single slot 15×15mm



Material: SS304, SS316 ■ Finish: satin finish (S), polish finish(P)



**G-01**

Item NO	∅
G-01-12-1-5000	12
G-01-16-1-5000	16
G-01-254-1-5000	25.4
G-01-381-1-5000	38.1
G-01-424-1-5000	42.4
G-01-508-1-5000	50.8
G-01-635-12-5800	63.5
G-01-762-12-5800	76.2
G-01-1016-2-5800	101.6
G-01-12-15-8000	12
G-01-16-15-8000	16
G-01-254-15-8000	25.4



**G-02**

Item NO	D1XD2
G-02-2513-1-5000	25x13
G-02-2525-15-5000	25x25
G-02-3030-15-5000	30x30
G-02-4040-15-5000	40x40
G-02-1515-15-5800	15x15
G-02-2020-15-5800	20x20
G-02-6030-15-5800	60x30
G-02-4020-2-5800	40x20
G-02-4040-2-5800	40x40
G-02-8060-2-5800	80x60
G-02-6040-25-5800	60x40
G-02-100100-25-5800	100x100



**CG-01**

Item NO	∅	L1XL2
CG-01-1515-381	38.1	15x15
CG-01-23513-381	38.1	23.5x13
CG-01-2424-424	42.4	24x24
CG-01-1515-424	42.4	15x15
CG-01-2730-483	48.3	27x30
CG-01-13815-508	50.8	13.8x15
CG-01-1515-508	50.8	15x15
CG-01-2020-508	50.8	20x20
CG-01-2540-60	60	25x40
CG-01-2020-63	63	20x20
CG-01-2525-63	63	25x25
CG-01-2525-75	75	25x25



**CG-02**

Item NO	D1XD2	L1XL2
CG-02-318318-1515	31.8x31.8	15x15
CG-02-7545-2025	75x45	20x25
CG-02-4040-2424	40x40	24x24
CG-02-6040-2424	60x40	24x24
CG-02-14050-2520	140x50	25x20

Material: SS304, SS316 ■ Finish: satin finish (S), polish finish(P)



**CG-03**

Item NO	∅	L1XL2
CG-03-1515-508	50.8	15x15
CG-03-2525-76	76	25x25



**CG-04**

Item NO	D1XD2	L1XL2
CG-04-8765-2530	87x65	25x30
CG-04-8040-2424	80x40	24x24

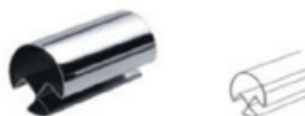

**CG-05**

Item NO	∅	L1XL2
CG-05-1515-508	50.8x1.5	15x15



**CG-06**

Item NO	U	G
CG-06-24	24	8-12

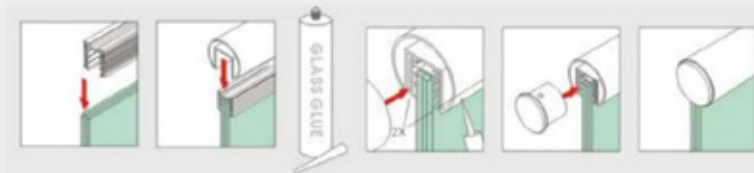

■ Material: SS304, SS316 ■ Finish: satin finish (S), polish finish(P)



**BL-01**

Item NO	W	T
BL-01-100	100	17.52(8-1,52-8)
BL-01-200	200	17.52(8-1,52-8)
BL-01-300	300	17.52(8-1,52-8)
BL-01-400	400	17.52(8-1,52-8)
BL-01-500	500	17.52(8-1,52-8)
BL-01-600	600	17.52(8-1,52-8)
BL-01-700	700	17.52(8-1,52-8)
BL-01-800	800	17.52(8-1,52-8)
BL-01-900	900	17.52(8-1,52-8)
BL-01-950	950	17.52(8-1,52-8)
BL-01-1000	1000	17.52(8-1,52-8)
BL-01-1100	1100	17.52(8-1,52-8)
BL-01-1200	1200	17.52(8-1,52-8)



**BL-02**

Item NO	W	T
BL-02-100	100	17.52(8-1,52-8)
BL-02-200	200	17.52(8-1,52-8)
BL-02-300	300	17.52(8-1,52-8)
BL-02-400	400	17.52(8-1,52-8)
BL-02-500	500	17.52(8-1,52-8)
BL-02-600	600	17.52(8-1,52-8)
BL-02-700	700	17.52(8-1,52-8)
BL-02-800	600	17.52(8-1,52-8)
BL-02-900	900	17.52(8-1,52-8)
BL-02-950	950	17.52(8-1,52-8)
BL-02-1000	1000	17.52(8-1,52-8)



**BL-03**

Item NO	W	T
BL-03-100	100	17.52(8-1,52-8)
BL-03-200	200	17.52(8-1,52-8)
BL-03-300	300	17.52(8-1,52-8)
BL-03-400	400	17.52(8-1,52-8)
BL-03-500	500	17.52(8-1,52-8)
BL-03-600	600	17.52(8-1,52-8)
BL-03-700	700	17.52(8-1,52-8)
BL-03-800	800	17.52(8-1,52-8)
BL-03-900	900	17.52(8-1,52-8)
BL-03-950	950	17.52(8-1,52-8)
BL-03-1000	1000	17.52(8-1,52-8)



**LHJGD-01**

Item NO  
LHJGD-01

■ Material: SS304, SS316 ■ Finish: satin finish (S), polish finish(P)



**T-01**

Item NO	φ
T-01-381	38.1
T-01-424	42.4
T-01-483	48.3
T-01-508	50.8



**T-02**

Item NO	φ
T-02-381	38.1
T-02-424	42.4
T-02-483	48.3
T-02-508	50.8



**T-03**

Item NO	φ
T-03-381	38.1
T-03-424	42.4
T-03-483	48.3
T-03-508	50.8



**T-04**

Item NO	φ
T-04-381	38.1
T-04-424	42.4
T-04-483	48.3
T-04-508	50.8



**T-05**

Item NO	φ
T-05-381	38.1
T-05-424	42.4
T-05-508	50.8

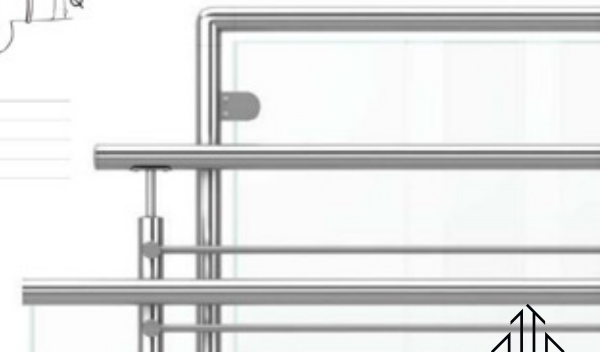

■ Material: SS304, SS316 ■ Finish: satin finish (S), polish finish(P)



**T-06**

Item NO	∅
T-05-381	38.1
T-05-424	42.4
T-05-483	48.3
T-05-508	50.8



**T-07**

Item NO	∅
T-07-381	38.1
T-07-424	42.4
T-07-483	48.3
T-07-508	50.8



**T-10**

Item NO	∅
T-10-381	38.1
T-10-424	42.4
T-10-483	48.3
T-10-508	50.8



**T-11**

Item NO	∅
T-11-381	38.1
T-11-424	42.4
T-11-483	48.3
T-11-508	50.8



**T-08**

Item NO	∅
T-08-381	38.1
T-08-424	42.4
T-08-483	48.3
T-08-508	50.8



**T-09**

Item NO	∅
T-09-381	38.1
T-09-424	42.4
T-09-483	48.3
T-09-508	50.8



**T-12**

Item NO	∅
T-12-381	38.1
T-12-424	42.4
T-12-483	48.3
T-12-508	50.8



**T-13**

Item NO	∅	B
T-13-381	38.1	100
T-13-424	42.4	120
T-13-508	50.8	120
T-13-635	63.5	150
T-13-762	76.2	175
T-13-1016	101.6	225

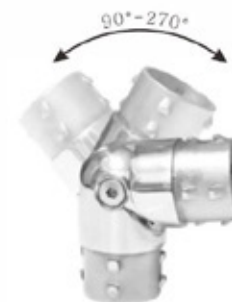

■ Material: SS304, SS316 ■ Finish: satin finish (S), polish finish(P)



T-14	
Item NO	∅
T-14-381	38,1
T-14-424	42,4
T-14-483	48,3
T-14-508	50,8



T-15	
Item NO	∅
T-15-381	38,1
T-15-424	42,4
T-15-508	50,8



T-16	
Item NO	A
T-16-4040	40x40
T-16-5050	50x50



T-17	
Item NO	A
T-17-4040	40x40
T-17-5050	50x50

■ Material: SS304, SS316 ■ Finish: satin finish (S), polish finish(P)



T-18		
Item NO	A	B
T-18-2515	25	15
T-18-3020	30	20



T-19	
Item NO	∅
T-19-381	38,1
T-19-424	42,4
T-19-483	48,3
T-19-508	50,8



T-20	
Item NO	A
T-20-5050	50,8x50,8



T-21	
Item NO	∅
T-21-495	49,5





Material: SS304, SS316 Finish: satin finish (S), polish finish(P)



T-22	
Item NO	∅
T-22-49	49



T-23	
Item NO	∅
T-23-508	50.8



T-24	
Item NO	∅
T-24-508	50.8



T-25	
Item NO	∅
T-25-508	50.8



T-26	
Item NO	∅
T-26-12	12
T-26-16	16



Material: SS304, SS316 Finish: satin finish (S), polish finish(P)

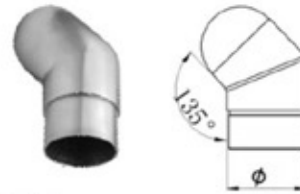

T-27	
Item NO	∅
T-27-424	42.4
T-27-508	50.8

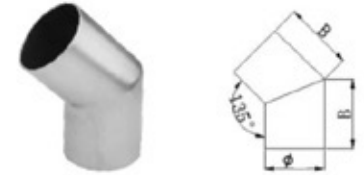

T-28		
Item NO	∅	B
T-28-381	38.1	44.3
T-28-508	50.8	59.5



T-29	
Item NO	∅
T-29-508	50.8



T-30		
Item NO	A	B
T-30-7648	76	48

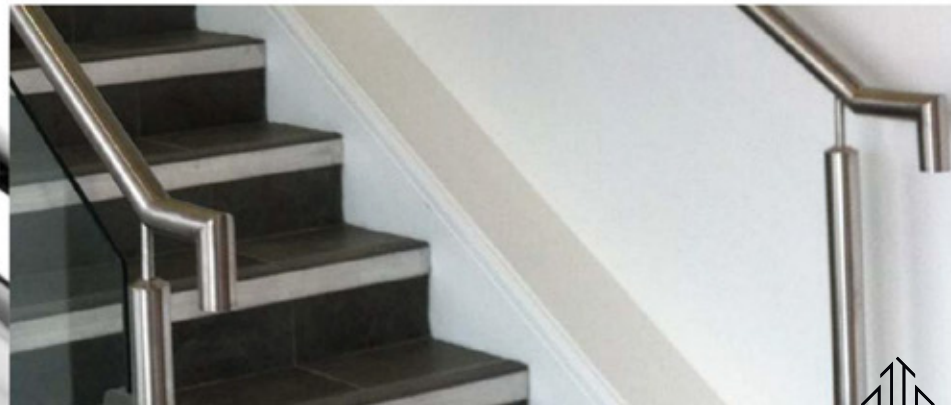

Material: SS304, SS316 Finish: satin finish (S), polish finish(P)



T-31	
Item NO	∅
T-31-16	16



T-32	
Item NO	∅
T-32-50.8	50.8

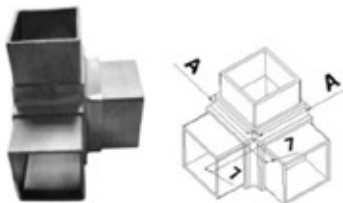

T-33	
Item NO	A
T-33-5050	50.8*50.8



T-34	
Item NO	∅
T-34-508	50.8

Material: SS304, SS316 Finish: satin finish (S), polish finish(P)



ZSG-01		
Item NO	∅	D
ZSG-01-16	16	85
ZSG-01-38.1	38.1	102
ZSG-01-42.4	42.4	102
ZSG-01-50.8	50.8	102
ZSG-01-63.5	63.5	102
ZSG-01-76.2	76.2	120
ZSG-01-101.6	101.6	150



ZSG-02		
Item NO	∅	D
ZSG-02-12	12	60
ZSG-02-16	16	60
ZSG-02-25.4	25.4	60
ZSG-02-38.1	38.1	60
ZSG-02-42.4	42.4	65
ZSG-02-50.8	50.8	74

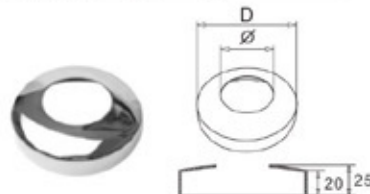

ZSG-03		
Item NO	∅	D
ZSG-03-38.1	38.1	100
ZSG-03-42.4	42.4	100
ZSG-03-50.8	50.8	100



ZSG-04		
Item NO	∅	D
ZSG-04-38.1	38.1	78
ZSG-04-42.4	42.4	78
ZSG-04-50.8	50.8	91

